

# Zamami Village Emergency Evacuation Map

## Aka Island • Geruma Island • Fukaji Island Ver.

### Emergency Contact

Name	Address	Telephone
Zamami Village Office	109 aza-zamami	987-2311

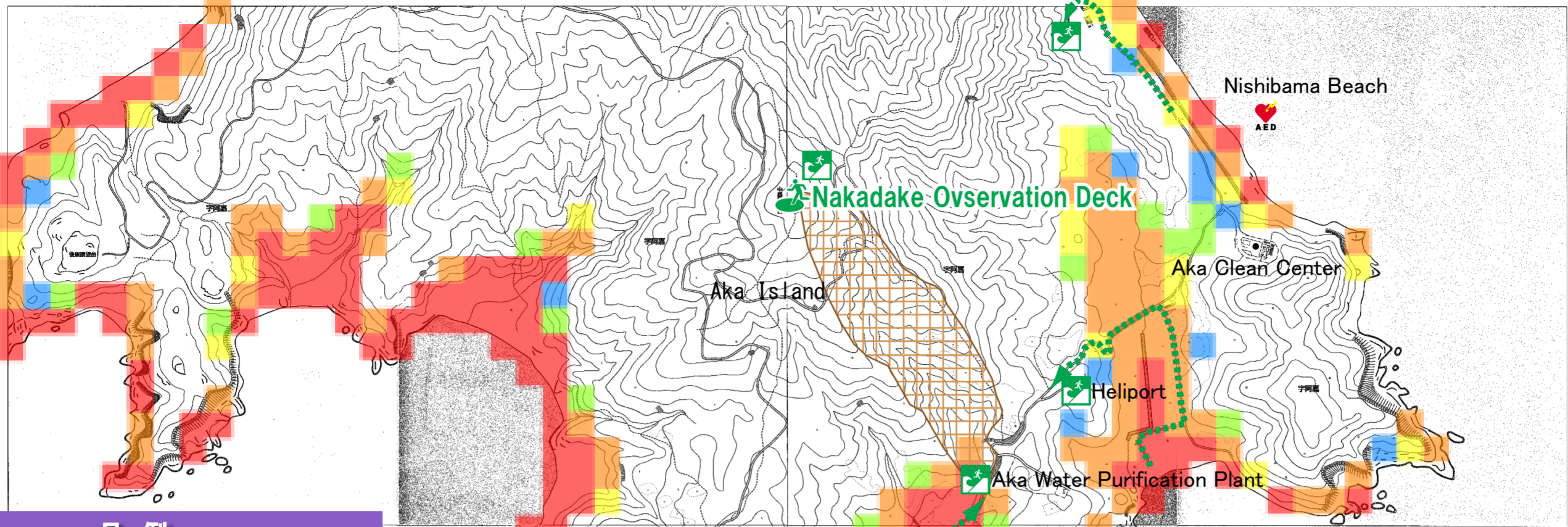

### 凡例

---	Border of District
○	Government Office
⊗	KOBAN, Police Station
⊗	School
〒	Post Office
+	Medical Office
—	Local Road
🚶	Evacuation Area
🚶	Evacuation Area at a tsunami attack
→	Refuge Route
❤️	AED Setting Point
🟦	Tsunami Inundation Expectation Area(20cm ~ 1m)
🟩	Tsunami Inundation Expectation Area(1m ~ 3m)
🟨	Tsunami Inundation Expectation Area(3m ~ 5m)
🟠	Tsunami Inundation Expectation Area(5m ~ 10m)
🔴	Tsunami Inundation Expectation Area(10m以上)
🏠	Erosion Control Area
📏	Steep Slope Fail Area
📏	Steep Slope Fail Spot
🗑️	Debris Flow Spot

※Sediment Disaster Prone Areas (Sediment Disaster Countermeasures for Sediment Disaster Prone Areas Act) is not applicable.

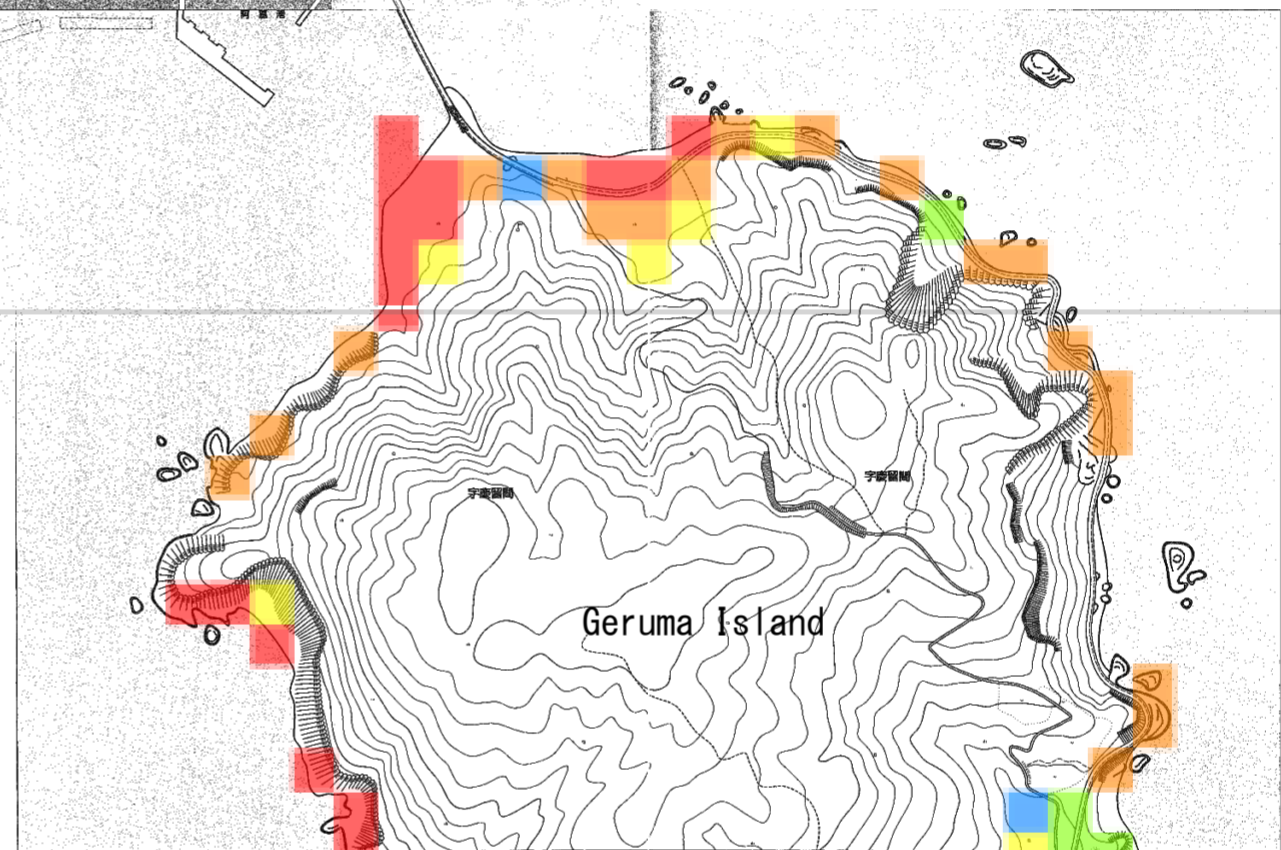
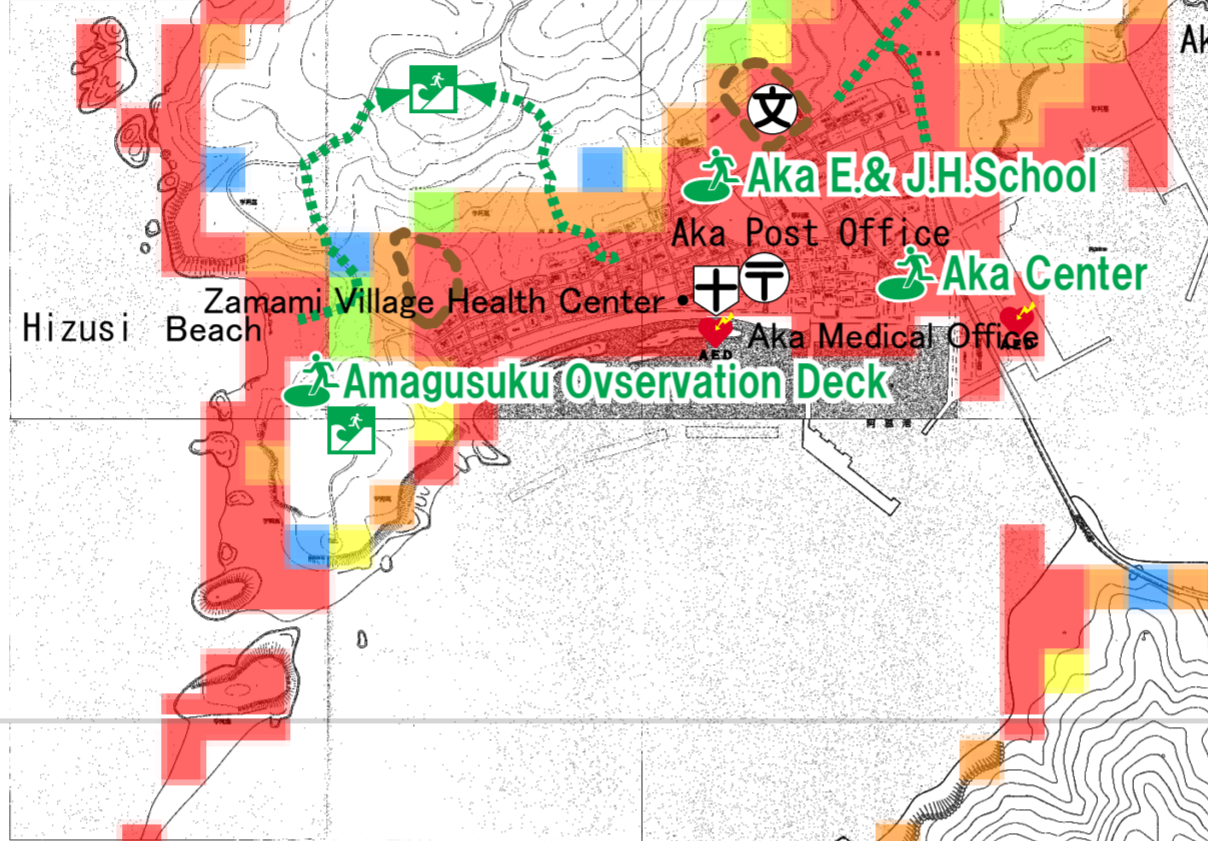

### Emergency Evacuation Center

Name	Address	Telephone
Aka E.& J.H.School	316 aza-aka	987-2123
Geruma E.& J.H.School	82 aza-geruma	987-2141
Aka Center	50 aza-aka	—
Geruma Public Hall	50 aza-geruma	—

### Tsunami Disaster Hill, Observation Deck

Name	Address	Telephone
Amagusuku Observation Deck	aza-aka	—
Nakadake Observation Deck	aza-aka	—
Fukaji Observation Deck	aza-geruma	—
Geruma Airport	aza-geruma	—
Shrine	aza-geruma	—

### AED Setting Point

Name	Address	Telephone
Aka Medical Office	68 aza-aka	987-2002
Aka Port terminal	936 aza-aka	—
Kitahama Beach(Only in Aug. Sep.)	aza-aka	—
Geruma Public Hall	50 aza-geruma	—

